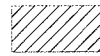
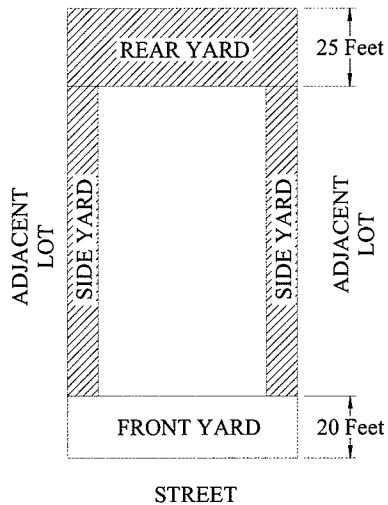

Figure #1
Inside Lot



Maximum 6 foot (72 inches) high in this area.



Maximum 3 and 1/2 foot (42 inches) in this area.

Note:

Side yard setbacks can vary from 3 to 15 feet.

No person shall place a fence, wall or other structure within a public right-of-way without an approved covenant as provided in subsection 4.03.040.d and any such fence is subject to the height requirement for the adjoining yard.

Figure #2
Rear Yard Adjoining Front Yard

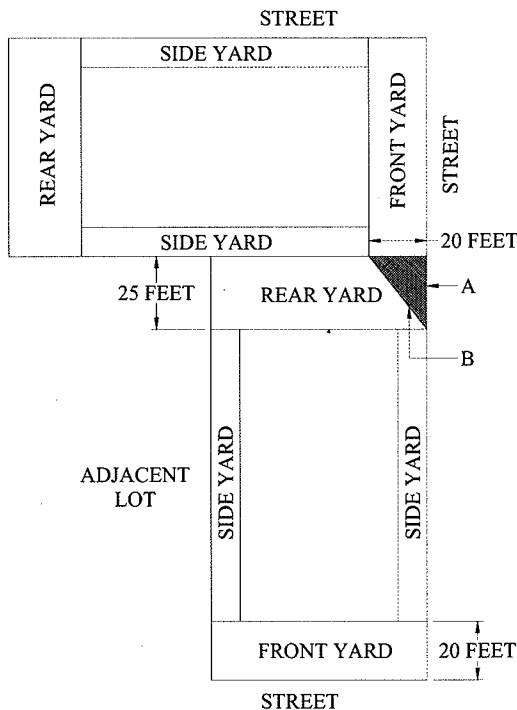

In an instance where a rear yard joins the front yard of another lot, the fence must be either:

- A. no more than forty-two inches high, or
- B. no more than six feet high and erected on a diagonal connecting the fencing in the side yard with the fencing in that part of the rear yard adjoining the side yard of the adjoining lot.

Figure #3

Curb to Fence Dimensions

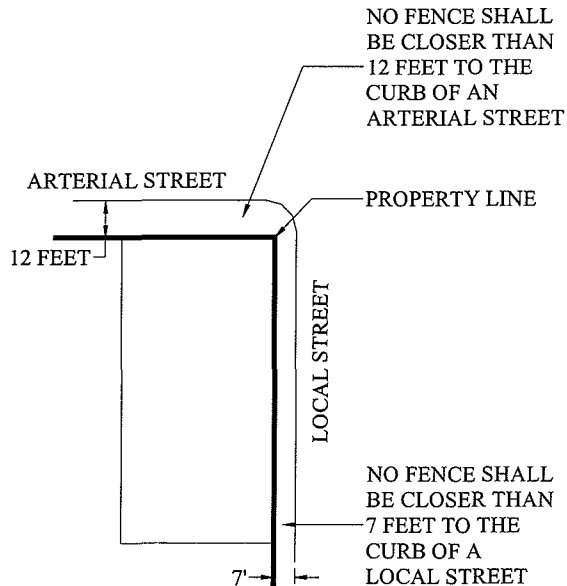

No person shall place a fence, wall or other structure within a public right-of-way without an approved covenant as provided in subsection 4.03.040.d and any such fence is subject to the height requirement for the adjoining yard.

Figure #4

Clear View Triangle

11.19.590 Fence and Walls – Prohibited and

Restricted: No fence, wall, hedge or other improvement may be erected or maintained in the corner of a lot so as to obstruct view of travelers upon the streets. A clear view triangle is based upon a measurement applied at street intersections, at intersections of streets and alleys, and at intersections of streets and commercial driveways to ensure unobstructed vision. Within the clear view triangle, the space between three and eight feet above street grade must be unobstructed. They are generally calculated as follows:

- The right isosceles triangle having sides of fifty feet measured along the curb line of each intersecting local access street; or
- The right triangle having a fifteen foot side measured along the curb line of a local access street and a seventy-five foot side along the curb line of the intersecting arterial street (this distance varies with speed limit. 75 feet is required for 30m.p.h.; 125 feet is required for 35m.p.h., etc.); or
- The right isosceles triangle having sides of seven feet measured along the right-of-way line of a local access street and seven feet measured along the right-of-way line of an alley.

